



NETBOX MEB-K

■ Product Specification

NETBOX MEB-K is a built-in power & data unit for seating furniture applications

■ Product Description

Comes in a 2-gang configuration
Cables are all hardwired
Customizable into various configurations
Plug-&-Play technology

■ Standard Set

Consists of basic components as well as NETBOX MEB, mounting bracket and cover plate. Fabric and cushion are not included.

■ Application Range

Lounge
Hotel room & lobby
Central zone
Foyer
Residential home

■ Technical Details

Material: ABS-FR; low concentration of heavy metal
Wiring:
3 x 1.5mm² standard
3 x 2.5mm² available upon request
Please follow standard electrical installation guidelines

A. & H. Meyer GmbH
Leuchten u. Büroelektrik
Fermke 8
32694 Dörentrup
GERMANY

T. +49 5265 94 88 0
F. +49 5265 94 88 11

A. & H. Meyer Sdn Bhd
(528797-M)
3, Jalan Astaka U8/84
Section U8, Bukit Jelutong
40150 Shah Alam
MALAYSIA
T. +60 3 7845 7277
F. +60 3 7845 2155
sales@ah-meyer.com.my

IN BUSINESS
ALL THINGS ARE
CONNECTED

www.ah-meyer.com.my





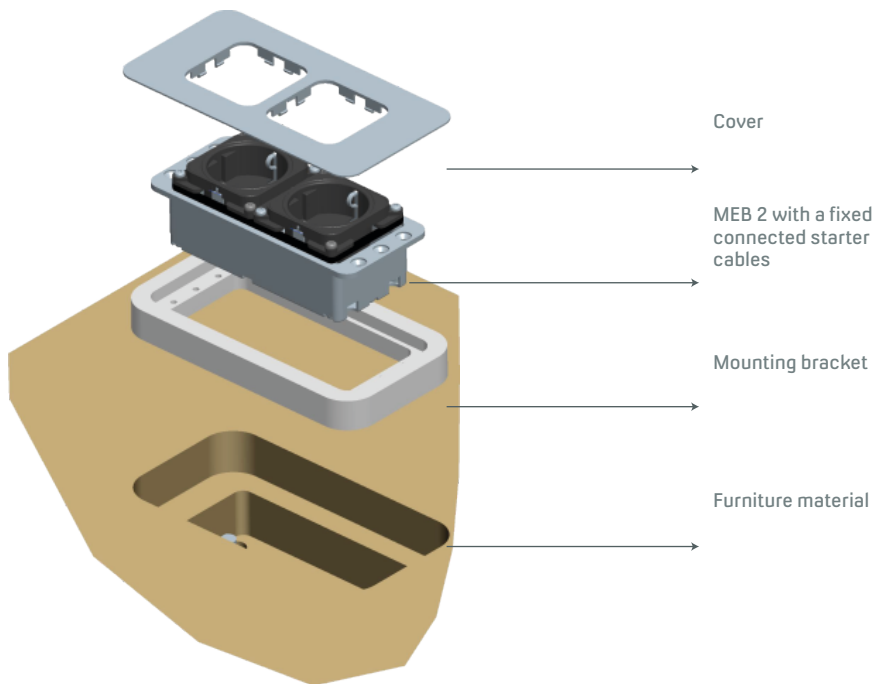

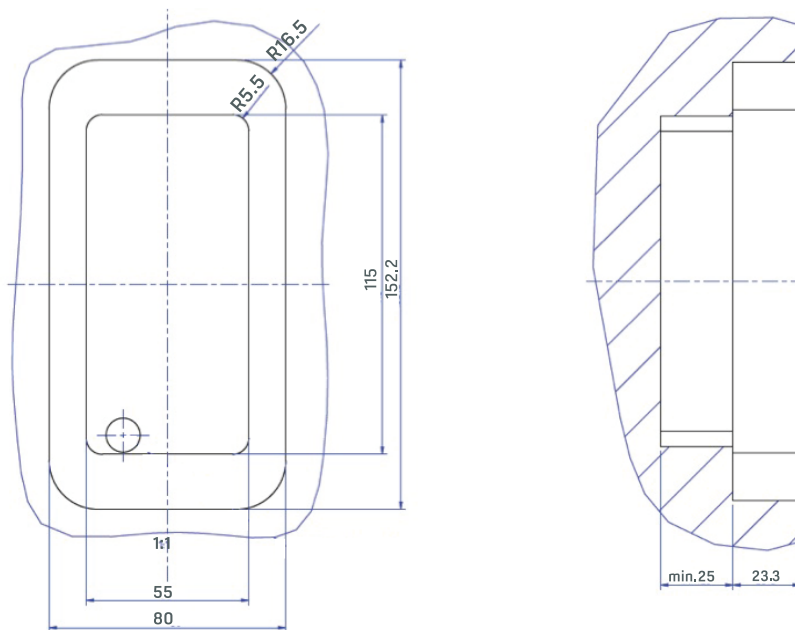

Dimensions



Cut-out drawing



Standards and Approvals

Country	Malaysia	Singapore, Hong Kong & India	Japan	Kingdom of Saudi Arabia	Germany & Indonesia	Korea
Standards	MS1144	SS241/ BS5733	J60884-1 (H20):2008	SASO2204 & SASO 443	IEC-VDE IEC 60884-1	K60884-1
Approvals/ Test Institute	 SIRIM	 TÜV-SÜD-PSB	 PSE	 DVE	 SASO	 KTR KOREA TESTING & RESEARCH INSTITUTE